

1 WELCOME

Welcome to the cutting edge of hands-free and wire-free technology for mobile phones. Here are the components to your Plantronics M1500 headset and adapter solution.

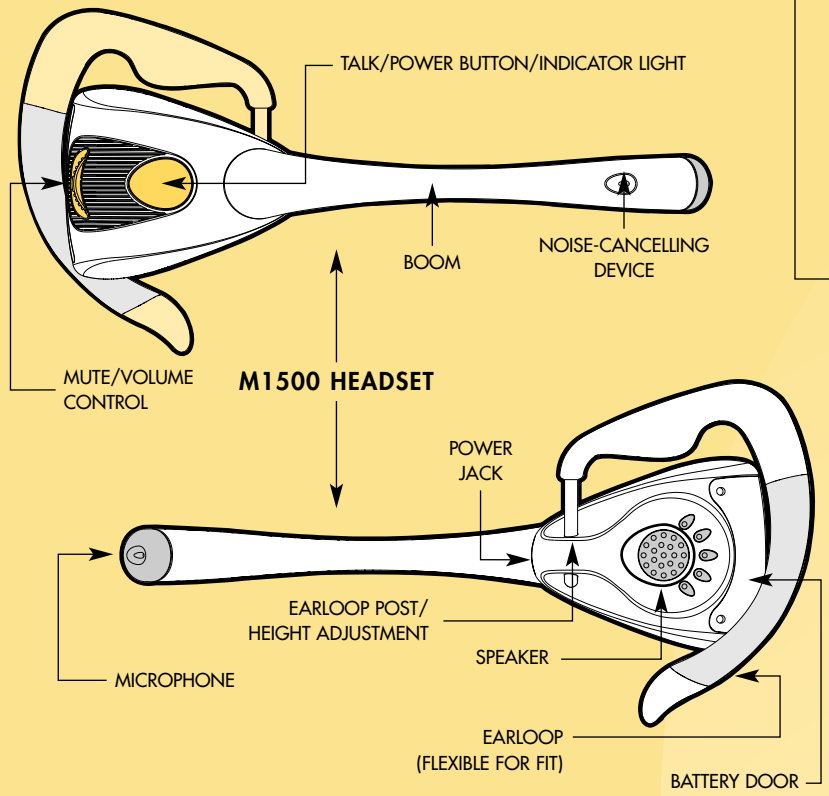

2 GETTING STARTED

Install, activate and charge the batteries.

FIG. 2.1 – Open the battery compartment by pulling on the two battery door latches. Remove the door.

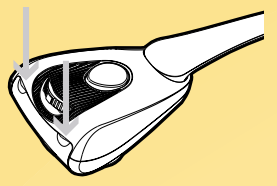

FIG. 2.2 – Insert battery into compartment so the (+) and (-) symbols correspond correctly. Replace battery compartment door by inserting the small tabs nearest the speaker and then snapping the door into place.

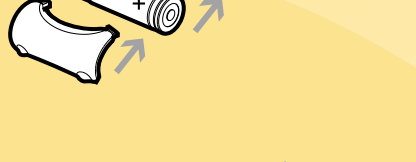

FIG. 2.3 – Locate the white vinyl strip protruding from the rear of the adapter unit. Remove the strip by pulling it directly out of the slot to activate the battery.

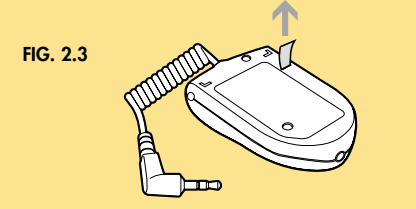
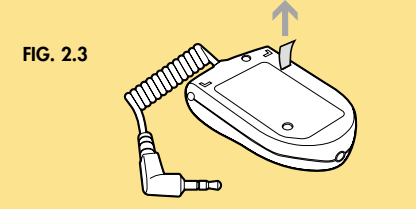
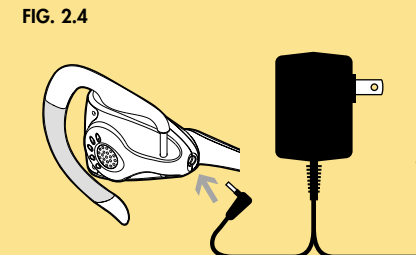

FIG. 2.4 – Connect the included wall charger to AC power and then to both the headset and adapter power jacks. In a few seconds, the INDICATOR lights will begin to blink. The INDICATOR lights will stop blinking and turn off when the headset and adapter are fully charged.



The first charge takes 2 hours; subsequent charges take just 1 hour. A fully charged headset and adapter will provide approximately 3 hours of talk time and 3 days of standby. Recharging your batteries each night will ensure your headset is ready for use the next day.

⊕ The batteries used in this product must be recycled or disposed of properly. Contact your local recycling center for proper disposal instructions.



3 CONNECTING TO YOUR HANDSET

You may attach the adapter unit directly to your handset or carry it separately in the supplied belt pouch. Before attaching the unit to your handset, place a few calls (see Section 5) and determine a position that provides the best audio performance.

FIG. 3.1 – ATTACHING DIRECTLY TO HANDSET

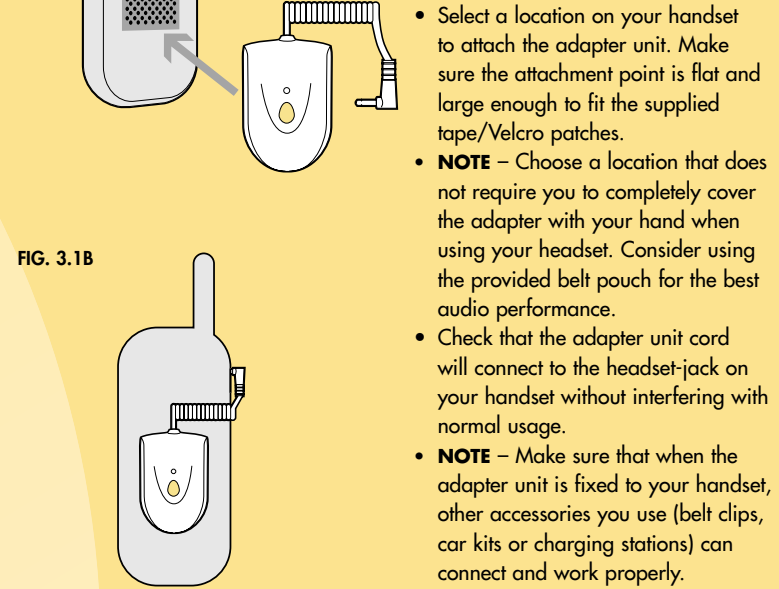

- Select a location on your handset to attach the adapter unit. Make sure the attachment point is flat and large enough to fit the supplied tape/Velcro patches.
- **NOTE** – Choose a location that does not require you to completely cover the adapter with your hand when using your headset. Consider using the provided belt pouch for the best audio performance.
- Check that the adapter unit cord will connect to the headset-jack on your handset without interfering with normal usage.
- **NOTE** – Make sure that when the adapter unit is fixed to your handset, other accessories you use (belt clips, car kits or charging stations) can connect and work properly.
- Peel the backing off one side of the tape/Velcro patch and attach it squarely to the back of the adapter unit.
- Peel off the other (exposed) side of the tape/Velcro patch and secure it to your handset.
- Now attach the adapter unit to your handset and connect the cord to the headset-jack. See your mobile phone user guide for instructions for connecting a headset.

5 USING YOUR HEADSET

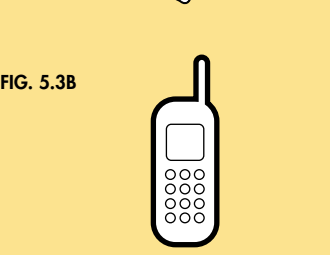
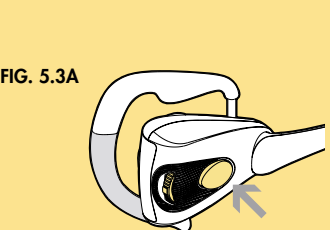
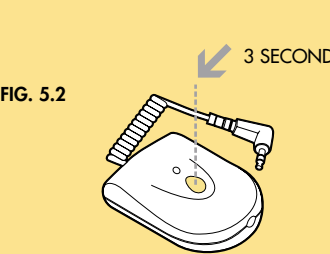
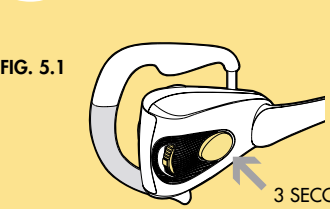

FIG. 5.1 – TURNING THE HEADSET ON AND OFF

- To turn your headset on, press and HOLD the blue TALK button until the button lights. The INDICATOR will light continuously for a few seconds and then turn off.
- To turn your headset off, press and HOLD the TALK button for about 3 seconds or until you hear a tone. The INDICATOR will flash twice and the headset will turn off.
- To check if your headset is turned on or off, hold the unit to your ear and ROTATE the MUTE/VOLUME dial. If you hear a tone, your headset is turned on.

FIG. 5.2 – TURNING THE ADAPTER ON AND OFF

- To turn your adapter on, press and HOLD the blue POWER button until the INDICATOR lights and then release. The INDICATOR will flash green while the unit is on.
- To turn your adapter off, press and HOLD the POWER button for about 3 seconds, or until the indicator turns red and then release. The INDICATOR will flash twice and the adapter will turn off.

FIG. 5.3 – HANDLING CALLS

- Make sure both your headset and adapter are turned on and the adapter is connected to your phone.

MAKING A CALL

- Press the TALK button on your headset to establish a connection between the headset and adapter. You will hear a tone and the INDICATOR lights on both the adapter and headset will begin to flash red.
- Dial using your mobile phone keypad and press the SEND key to place a call. You will hear the call progress in your headset.
- When your call is complete, press the TALK button on your headset to disconnect the adapter. The INDICATOR light on the adapter will return to flashing green.

NOTE—To prevent shortened battery life, make sure the adapter INDICATOR light is flashing green between calls. If the adapter INDICATOR light is flashing red and you are not using your headset, press the TALK button on the headset to disconnect the adapter.

ACCEPTING A CALL

- As soon as your handset rings, press the TALK button on your headset to establish a connection between the headset and adapter. You will hear a tone and the INDICATOR lights on both the adapter and headset will begin to flash red.
- Answer the call using your handset SEND key.
- When your call is complete, press the TALK button on your headset to disconnect the adapter. The INDICATOR light on the adapter will return to flashing green.

FIG. 5.4 – ADJUSTING THE VOLUME

- To increase volume, ROTATE the MUTE/VOLUME dial up and release (for headset usage on right ear).
- To lower volume, ROTATE the MUTE/VOLUME dial down and release (for headset usage on right ear).
- Also adjust the volume on your handset.

NOTE—If using the headset on your left ear, reverse the instructions, rotating down to raise volume, and up to lower it.

FIG. 5.5 – MUTE FUNCTION

- To mute the microphone while on a call, PUSH IN on the MUTE/VOLUME dial. A tone, followed 2 seconds later by a reminder tone, indicates mute function.
- To disable the mute, PUSH IN on the MUTE/VOLUME dial again. A beep indicates Mute function is off.

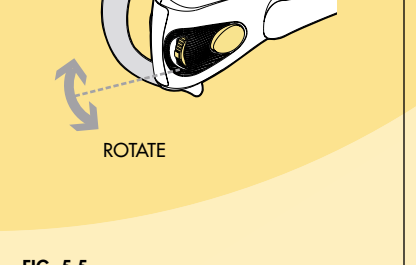
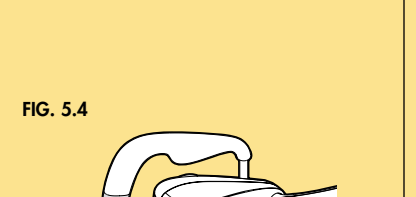

4 GETTING THE PERFECT FIT

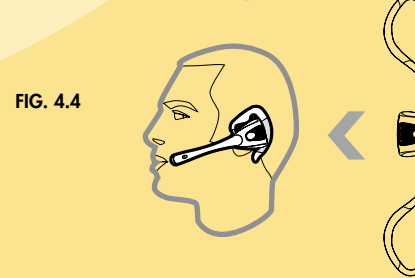
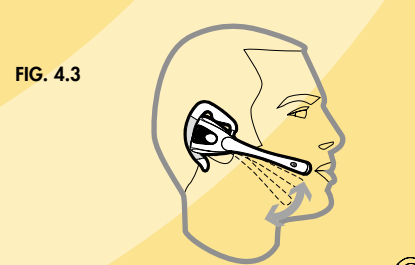
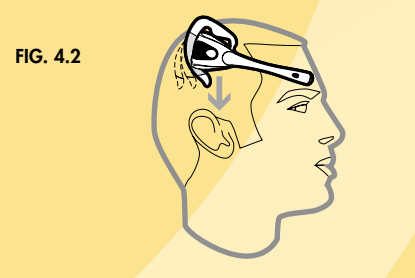
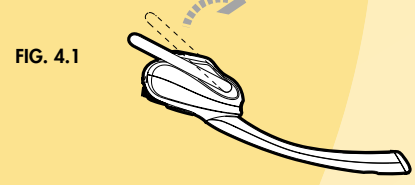

Customize your headset so that it fits comfortably.

FIG. 4.1 – Rotate the earloop outward.

FIG. 4.2 – Position the headset over your right ear so that the earloop slides behind your ear. Bend the flexible earloop to achieve a snug, comfortable fit.

FIG. 4.3 – Adjust the microphone BOOM so it is aligned with your mouth.

FIG. 4.4 – For left ear usage, simply remove the earloop from the headset, flip the headset over and reinsert the earloop on the opposite side. After completing this step, follow the fit instructions above — except using your left ear.

NOTE – If the speaker sounds soft or feels uncomfortable, slide the headset up or down along the earloop post so that it is centered on your ear when fitted.

FIG. 3.2 – USING THE BELT POUCH

- Open the pouch and slide in the adapter unit with the power jack facing down.
- With the pouch open, slip the adapter cord through the rectangular slot in the top flap and close the pouch.
- Slide the pouch onto your belt and attach the adapter cord to your handset.
- When using the belt pouch, remember to unplug the adapter before you answer or make a call using your handset.

